

NOTES

* MINIMUM CENTRE TO CENTRE DISTANCE 30 mm

MOUNTING MATERIALS INCLUDED

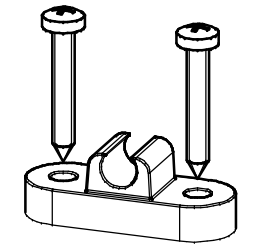

CABLE CLAMPS
4 PER METER CABLE LENGTH

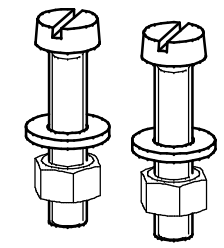

2 MOUNTING SCREWS
M5X25 WITH WASHERS AND NUTS
PER NOZZLE

OPTIONAL VALVE
1/8 BSP FEMALE - FEMALE
P/N 9146982101

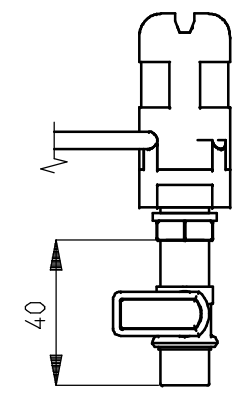
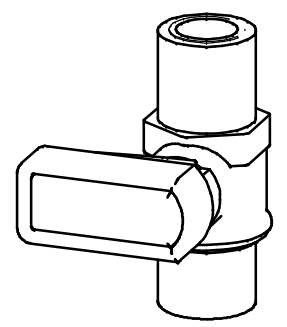

<p>SIMCO ION An ITW Company www.simco-ion.nl Tel.: +31 (0)573 288333</p>	Name: Nozzle type HE (non shielded cable)					Drawn: AB	Part no.: 1606xxxxxx
	CAD generated NOT updated	Dimensions in mm	Date: 23-11-2018	A3	M: 1:1	ECN2018-028	Check: -